

## DESCRIPTION:

Patent pending luminaire, Directional SunStar50, is one of the brightest IC rated can light equivalents on the market at its extremely small size (2" Ø by 3" H). Energy efficient, innovative, and lightweight the 6.5W SunStar50M1X3-EB is a 50W 4" traditional directional can light equivalent without the bulky necessities of a traditional can. SunStar50 Eyeball comes in a standard version with a 90° beam and an optional diffused version with a 110° beam. With super bright energy efficient LEDs, the Eyeball SunStar50's low profile, rugged construction, and integrated ability to rotate make this 124 lm/watt (SR50M1X3-EB) can light the right choice for illuminating any installation where the best illumination, directionality, wall washing, and energy savings are needed.

## SPECIFICATIONS:

### LUMINAIRE:

Total luminaire length 3".  
2" diameter housing with matching aluminum trim that locks rotating head in place.

### CONSTRUCTION:

Extruded aluminum housing has a diameter of 2". Metal mounting bracket is tension fit to fixture and ceiling with no exposed fasteners.

### MODULE:

One three chip LED module utilizing Sunlite patented application specific technology with four standard color temperature options (2700K, 3500K, 4100K, and 5500K).

### CONTROLS:

0-10V Dimming when utilizing suggested dimming AC-DC driver fixtures dim down to 10%. Smart lighting compatible.

### OPTICS:

Optical system consists of milled aluminum primary optic, clear glass lens, and aluminum reflector housed in a rotatable milled aluminum sphere. Translucent plastic diffuser optional.

### FINISH:

Standard finish for housing is anodized aluminum. Consult factory for custom colors.

### ENVIRONMENT:

Damp location rated. Fixture operating temperature -30° C to 40°C.

### WARRANTY:

Ten-year warranty for indoor fixture. Five-year warranty for outdoor fixture and driver. Terms and conditions apply.

### ELECTRICAL:

SunStar50M1X3-EB setup consists of multiple fixtures and a [0-10V dimming] AC-DC driver. Fixture input wattage is 6.5W for 693 delivered-lumen package per 3500K fixture. SunStar50 contains an LED shunt protection device.

Must Specify Driver. Specify 110V to 277V to driver. Wire lights in series with 18AWG CL2/18-2. For special circuiting or wire gauge, consult factory.

### LIFETIME:

Designed and built to last over 60,000 hours.

### VALIDATION:

UL/cUL listed.

### SHIPPING:

Approximate net shipping weight is 0.3 lbs (0.12 kgs).



PROJECT:

PRODUCT:

LOCATION:

CONTACT:



**SUNSTAR50-EB**  
**ROTATABLE CAN**  
**LIGHT**  
**SR50M1X3-EB**

**SOLID STATE LED**

**USE:**

**TRADITIONAL**  
**50W/4" CAN**  
**EQUIVALENT**

## DIMENSIONS:

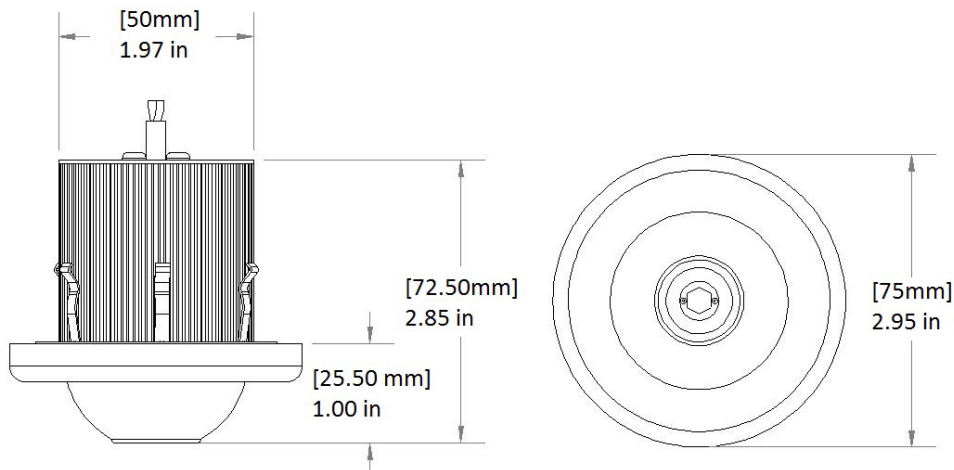

**E338721**

**CONTACT:**

4811 Quail Crest Place  
Lawrence, KS 66049  
www.sunlitest.com  
T:785.856.0219

**CERTIFICATION:**

UL and cUL  
Damp Location Listed  
IP64 Rated

**ENERGY:**

>0.9 Power Factor  
700mA / ~10VDC  
-30° C to 40°C  
6.5W

**SHIPPING:**

Approx. Net Weight  
0.3 lbs (0.12 kgs)

# CATALOG NUMBER:

EXAMPLE PRODUCT CODE: SR50M1X?-EB-0700-SV-35-D

\_\_\_\_\_ - \_\_\_\_\_ - \_\_\_\_\_ - \_\_\_\_\_ - \_\_\_\_\_ - \_\_\_\_\_ - \_\_\_\_\_

PRODUCT	LED MODULE SIZE	HOUSING	CURRENT	HOUSING COLOR	COLOR TEMPERATURE	DIFFUSER						
SR50	M1X3	1 MODULE 3 CHIP	EB	EYEBALL	0700	MA	SV	SILVER	55	5500K	D	WITH DIFFUSER
							BK	BLACK	41	4100K		
									35	3500K		
									27	2700K		
									SB	SOLID BLUE		
									SG	SOLID GREEN		
									SR	SOLID RED		
		RGB	RGB									

## RECOMMENDED DRIVERS:

### BASIC DRIVERS AND WIRING (UP TO 6 FIXTURES IN A SERIES)

NON-DIMMABLE DRIVERS					
LPLC-18-700		LPC-35-700			
1 OR 2 IN A SERIES		3 TO 5 IN A SERIES			
DIMMABLE DRIVERS					
LUC-010S070DSM	LUC-018S070DSP	EUC-026S070DSC	EUC-042S070DSC	LUC-24S070DSW (NO WIRES)	LUC-42S070DSW (NO WIRES)
1 FIXTURE	2 IN A SERIES	2 OR 3 IN A SERIES	3 TO 5 IN A SERIES	2 OR 3 IN A SERIES	3 TO 5 IN A SERIES
LPF25D-36 (DIM TO OFF)					
3 IN A SERIES					

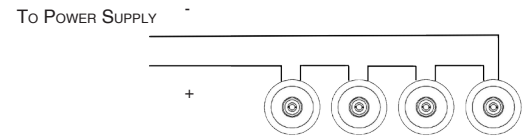

CALL FOR SPECIALTY DRIVER OPTIONS

## LUMEN OUTPUT:

COLOR TEMPERATURE	WATTAGE	LUMEN	CRI
2700K	6.5	659	80
3500K	6.5	693	80
4100K	6.5	728	80
5500K	6.5	804	75

## QUANTITY ESTIMATOR:

ROOM SIZE	20FC	35FC	70FC
10'X10'	5	8	15
20'X20'	14	24	45
30'X30'	30	48	96

SIMULATION BASED ON 10' CEILING HEIGHT STANDARD REFLECTANCE 80/50/20, FC = FOOT CANDEL

## PHOTOMETRICS:

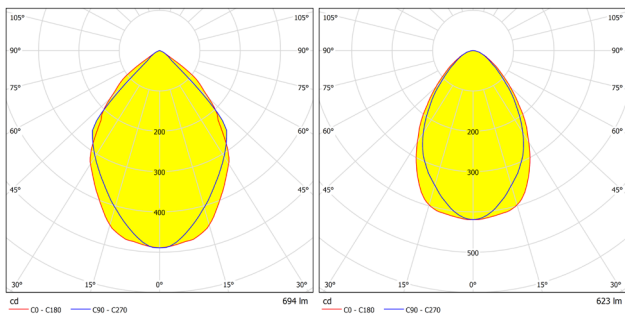

SR50M1X3-EB-35

SR50M1X3-EB-35-D

## DUV RANGE:

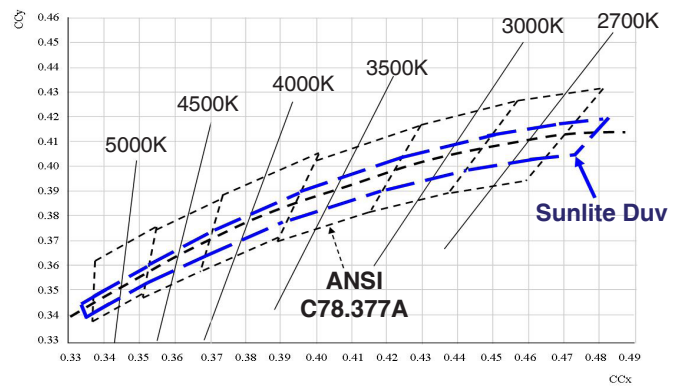

## TYPICAL MOUNTING CONFIGURATIONS:

